

# MS837 QUICK START GUIDE



The Unitech MS837 Laser Scanner  
Installation Instructions and Popular Configuration Settings

## SETUP AND INSTALLATION

The following steps will walk you through the installation process.

## CONNECTING AND DISCONNECTING THE INTERFACE CABLE

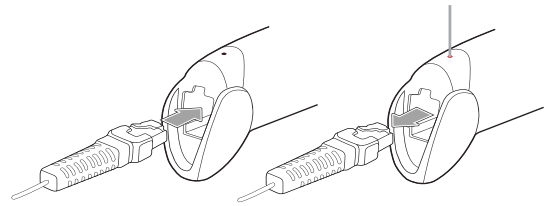

An audible "click" sound indicates the interface cable has been plugged in correctly and the connector lock is engaged. To unplug the interface cable, release the connector lock by inserting one end of a paperclip into the handle.

## CONNECTING USB CABLE TO A HOST

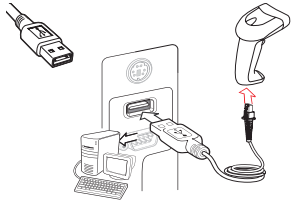

Plug the interface cable into a free USB port of a host computer. The MS837 is now ready to use.

## TEST & FINISH

Open a word processing program such as Microsoft Word or Notepad on your host. Now scan the following barcode:



If the word "Unitech" appears on the screen you have successfully installed your scanner. Congratulations!

## SETTINGS AND CONFIGURATION

The following section covers the most common configuration settings for your MS837 scanner.

For additional configuration options please visit [unitechscanners.com/MS837](http://unitechscanners.com/MS837) and select the "Download" tab. You will find the User's Manual and a variety of other resources.

## FLASH MODE



1



2

Scan this set of barcodes to switch to Flash Mode from the default Trigger Mode. In Flash mode, the MS837 will function automatically. It will scan at a set interval.

## TRIGGER MODE



Trigger Mode

Scan here to switch back to Trigger Mode. In Trigger Mode, the MS837 will scan only when the scanner button is pressed.

## TAB MODE



1



2

You may wish to set your scanner to "Tab Mode." In this mode, data will tab over to the next column as you scan instead of jumping to the next line. Scan the top barcode and then the bottom barcode to switch to Tab Mode from the default Enter Mode.

## ENTER MODE



Scan here to return to Enter Mode.

## DEFAULT SETTINGS



This barcode will return your scanner to its original factory settings, a useful feature for troubleshooting purposes.

## GOOD READ / BAD READ



## HOW CAN WE HELP YOU?

The MS837 is a plug-and-play scanner. It does not require a driver and should be recognized as a generic HID device by your computer, similar to a standard keyboard. This allows you to scan into any field that you could normally type into.

Unitech's professional support team is available to quickly answer questions or technical-related issues. Should equipment issues occur, please contact a Unitech Service Representative at (800) 851-8648 for more information.